

## Heating Pad For EEL JK BMS Battery Box

### USER MANUAL



**Shenzhen EEL Battery Co., Ltd**

# Heating Pad Connection Guidelines

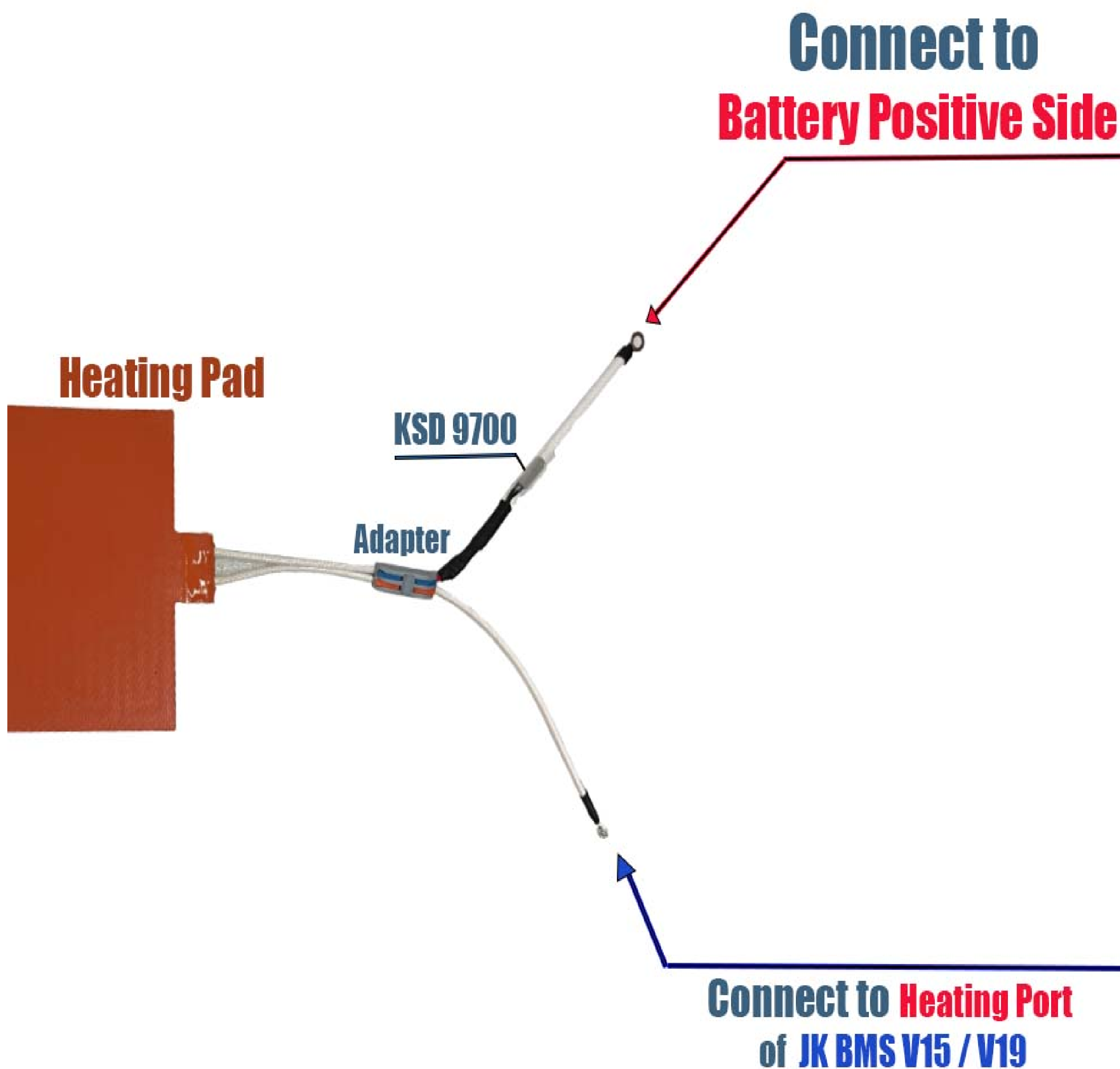

**1.Lay the epoxy sheets on the bottom of the battery box as shown in the picture.**

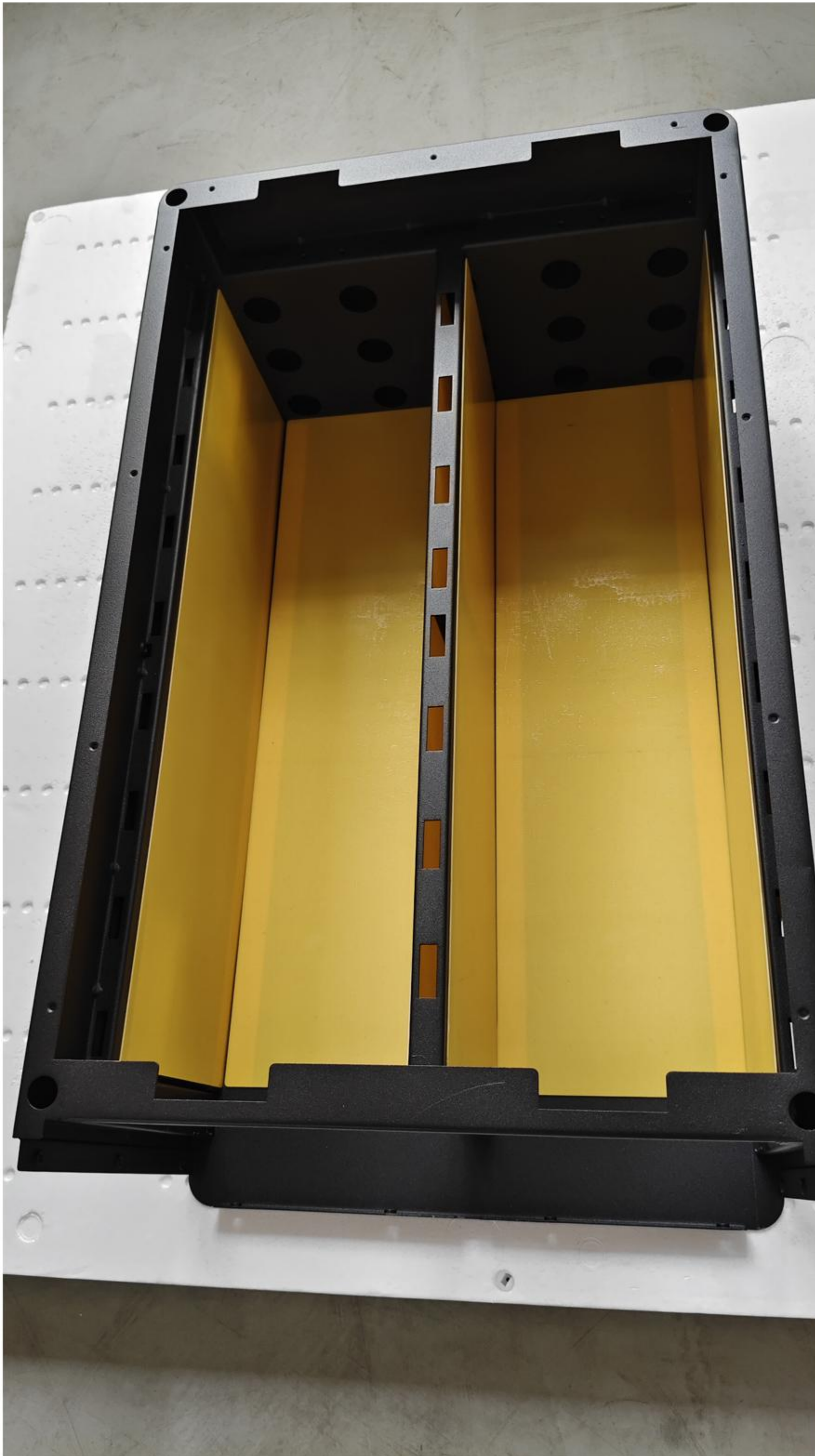

2 .Lay the heating pad flat on top of the epoxy board.



**3. Connect the heating pad socket to the adapter plug.**



## 4. Connect the Adapter to the Heating Port for Jikong BMS - V15 Version

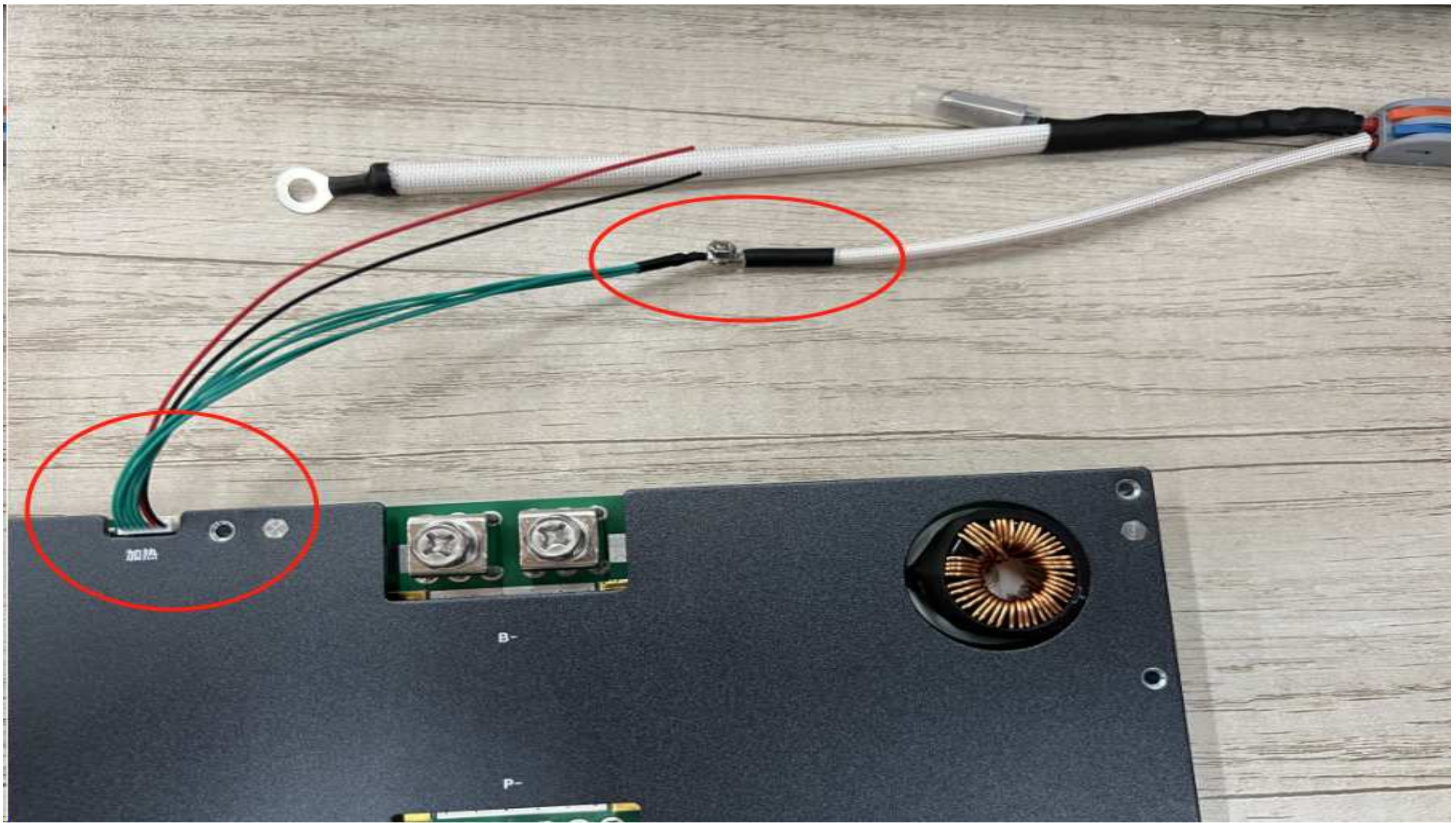

## for Jikong BMS - V19 Version



5. According to the diagram, install the other terminal of the adapter cable on the total positive terminal inside the battery pack.

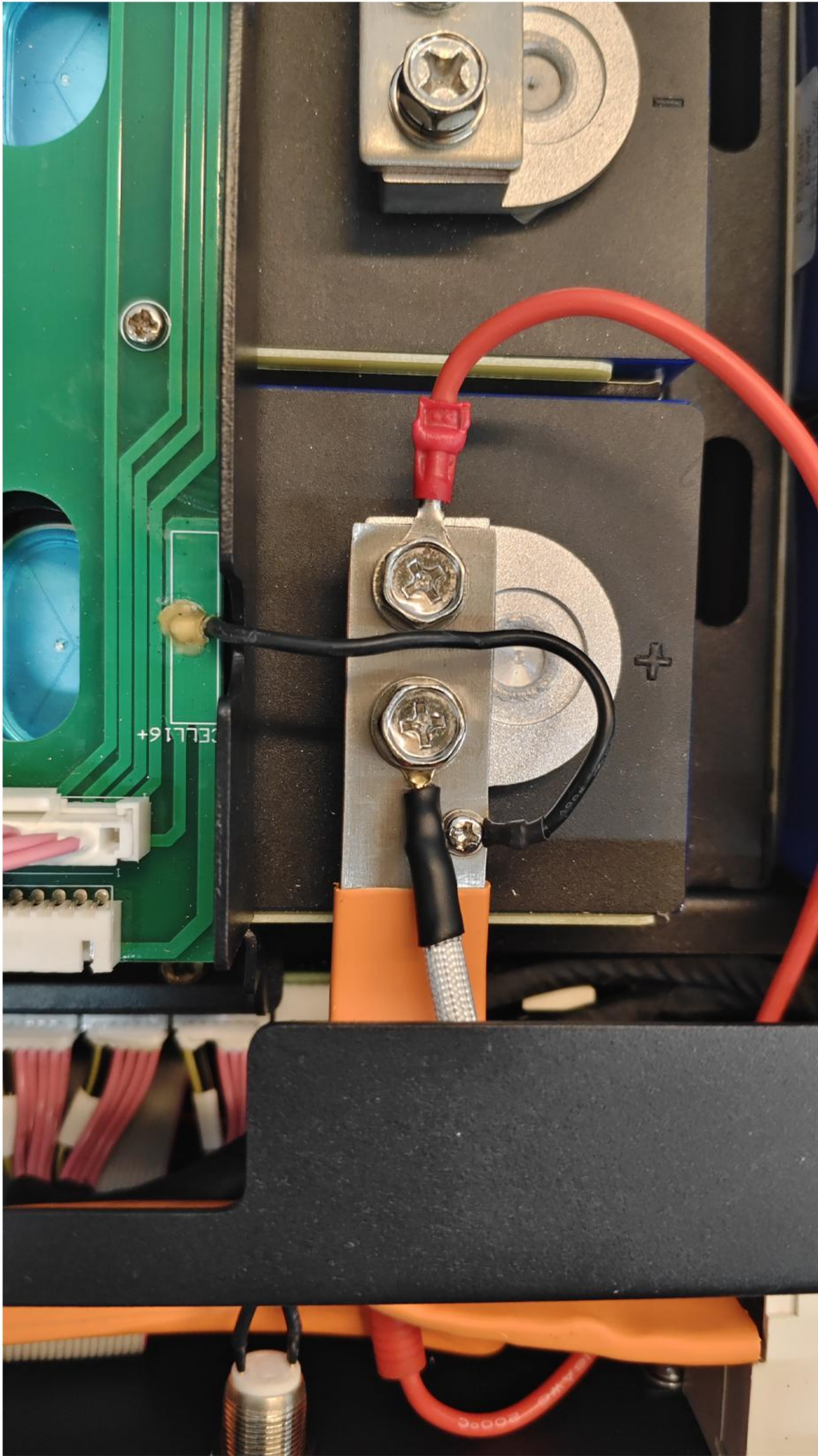

6. Open JK BMS App and enter the authorization password 123456.

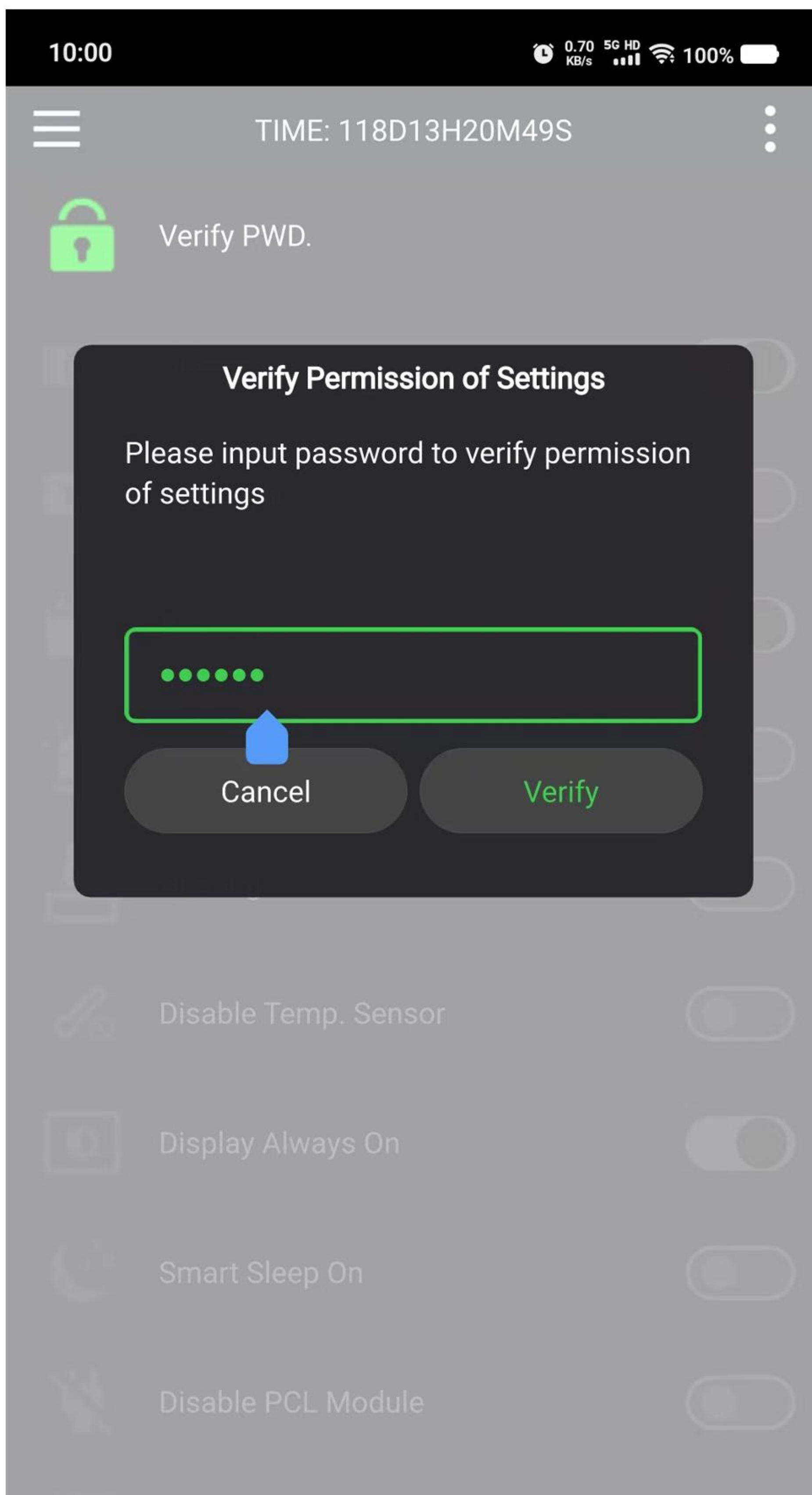

## 7. Turn on the BMS heating function in the app.

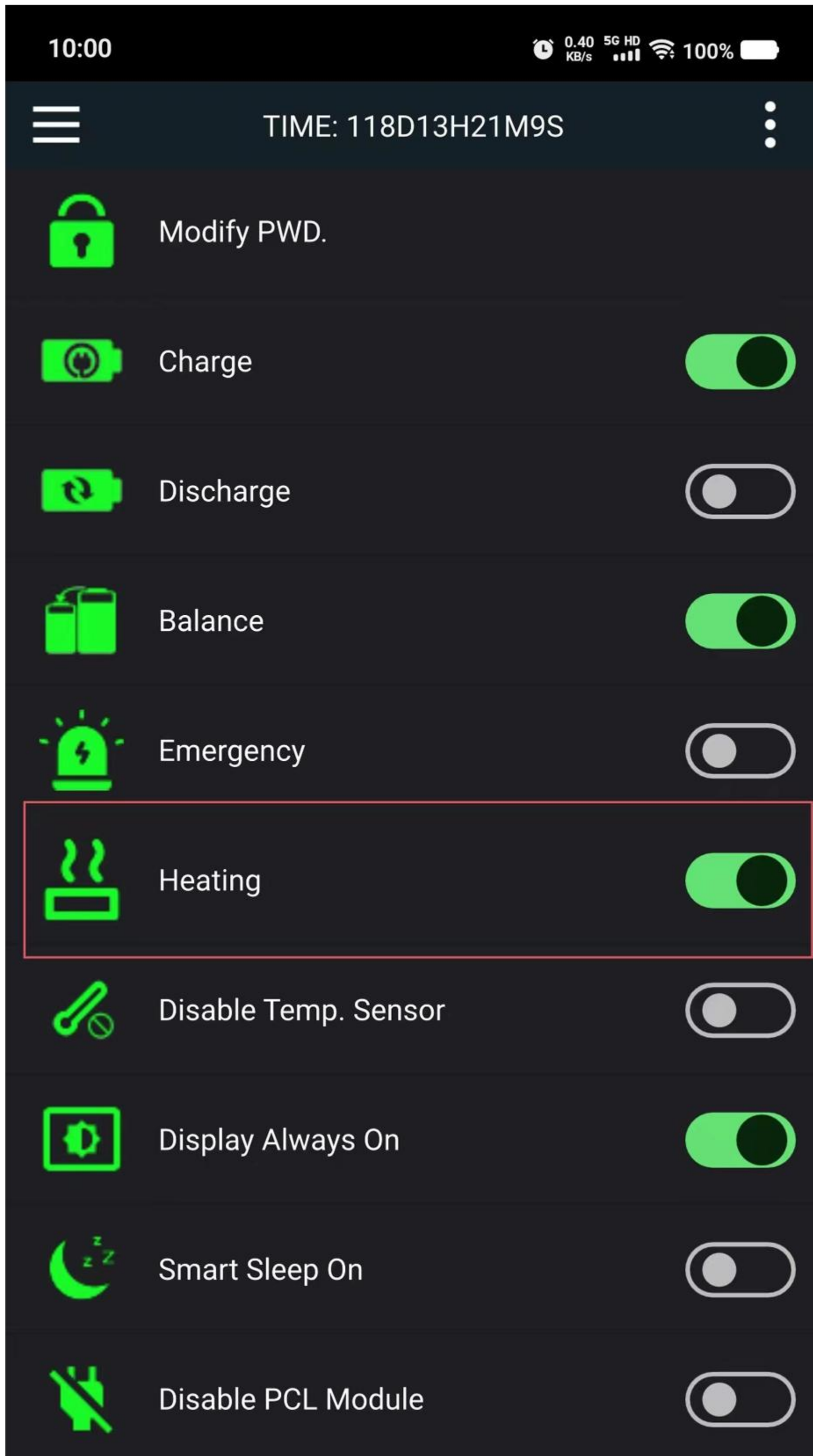

8. In the heating function settings, adjust to the appropriate temperature range as needed.

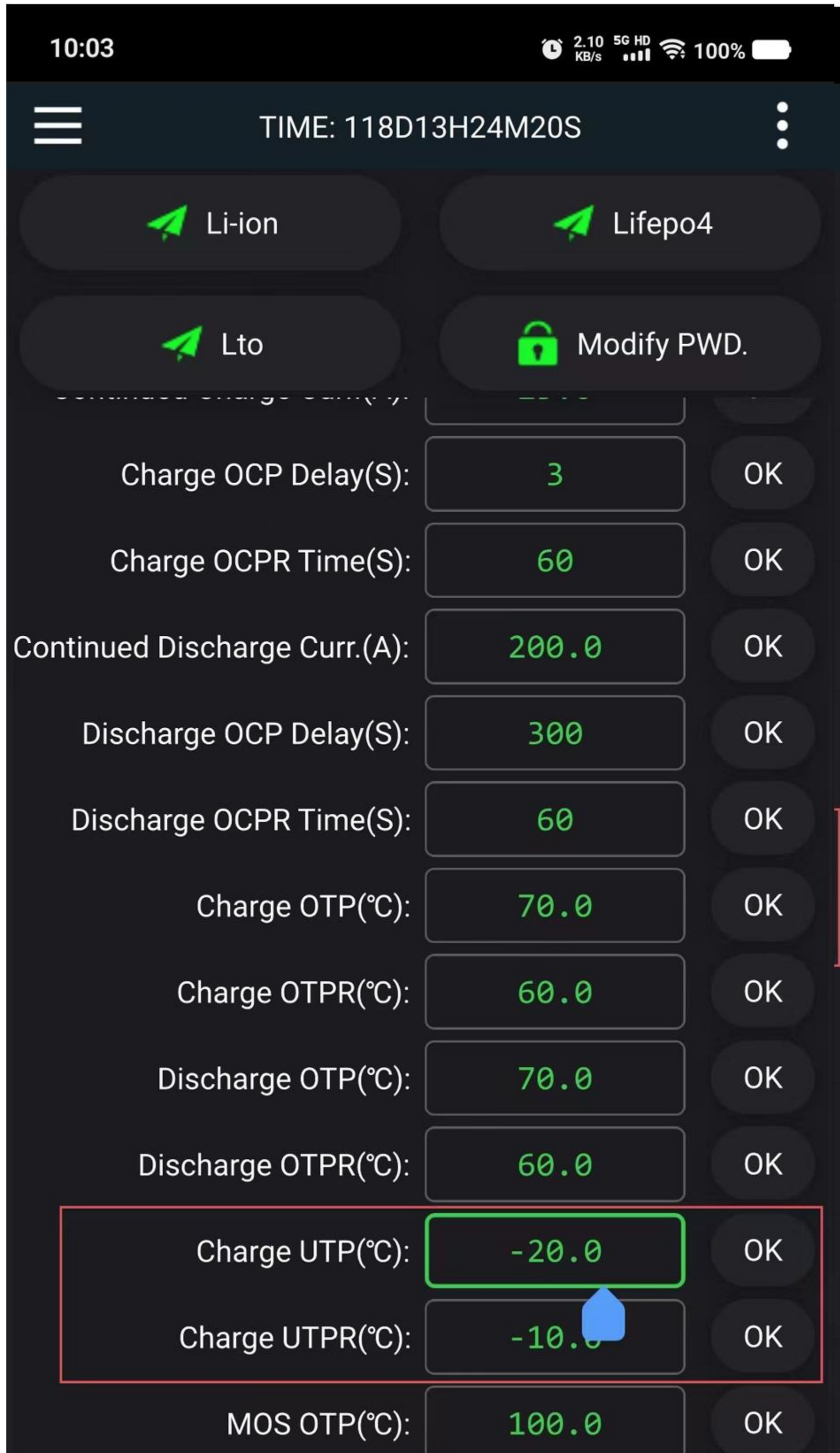

The heating pad is suitable for JK BMS with heating function (such as PB2A16S20P / B2A8S20PH).

Whether the heating pad is heated depends on several conditions:

1. Whether the heating function is turned on in the BMS.
2. Whether the ambient temperature is lower than the UTP temperature you set.

**The working logic of this heating pad is:**

After you turn on the heating function of the BMS, when the ambient temperature is lower than the UTP temperature you set, the heating pad starts to work until the BMS detects that the temperature is higher than the UTPR temperature you set, and the heating pad stops working.

\* This heating pad built-in a [ Closed Temperature Switch ].

When the ambient temperature is higher than 45 degrees Celsius, the heating pad will stop working regardless of whether the BMS disconnects the heating function of the heating pad.

This ensures that the heating pad will not damage your battery cells in the event of a BMS failure.